

# LEVITY

## User Manual for the Smart Rope

This manual shows you how to use the smart rope. Please read this manual carefully before using the product and keep it properly. Thank you for buying the LEVITY Smart Rope.

### 1. Download Paiactive APP



*Paiactive*

Search for "Paiactive" in the app store to download the app  
OS support: Android5.1, iOS 9.0 and above

### 2. Device Binding

1. Turn on Bluetooth on your cellphone;
2. Open the Paiactive APP to register/login, and then add "Smart Rope" in "Device-Add Device".

### 3. Buttons & Charging

1. Activate the Device: a short press on the left/right button to activate the device.
2. Switch the Mode: a long press on the left button for 2 seconds to switch the mode.
3. Reset the Mode: a long press on the right button for 2 seconds to reset the mode.
4. Restart the Device: a long press on the right button for 8 seconds to restart the device.
5. Charge the Device: the charging port is located at the end of the main handle (if it's T20NA or T20EU, you need to unplug the silica gel plug). Please charge the device with a standard 5V charger and a standard Micro USB charging cable.

### 4. Display

1. Battery icon: it shows the current battery status; when the icon flashes, please charge the device.
2. Exercise mode: it shows the current exercise mode, which includes free mode, time down (skipping time) and count down (skipping count).
3. Time: it shows the skipping time or remaining time.
4. Count: it shows the count of skips done or the count of remaining skips.

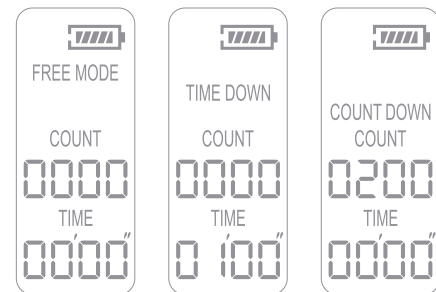

### 5. Installation

T20NA  
T20EU

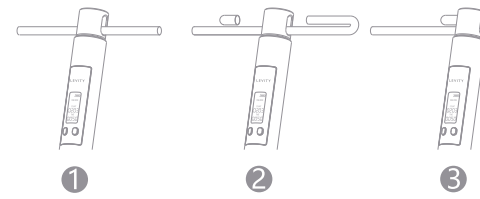

T20LNA  
T20LEU

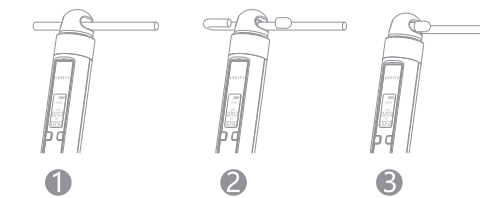

### Daily maintenance and matters need attention:

1. This product is not waterproof, so do not use it outdoors in rainy days.
2. When charging, please plug and unplug gently to avoid any damage.
3. Please use a piece of dry cloth when wiping the handles. Don't use a wet one.
4. Please carefully evaluate your fitness condition and have a warm-up before your start rope skipping.

### If the device doesn't work, please try the following:

1. Please charge the device to ensure sufficient power.
2. Check your cellphone to make sure the Bluetooth is on.
3. Turn off the Bluetooth and turn on it again on your cellphone.
4. Restart your cellphone.
5. Restart the device and rebind it to your phone.

### FCC Caution

This device complies with part 15 of the FCC Rules. Operation is subject to the following two conditions:

- (1) This device may not cause harmful interference, and
- (2) this device must accept any interference received, including interference that may cause undesired operation.

Any Changes or modifications not expressly approved by the party responsible for compliance could void the user's authority to operate the equipment.

Note: This equipment has been tested and found to comply with the limits for a Class B digital device, pursuant to part 15 of the FCC Rules. These limits are designed to provide reasonable protection against harmful interference in a residential installation. This equipment generates uses and can radiate radio frequency energy and, if not installed and used in accordance with the instructions, may cause harmful interference to radio communications. However, there is no guarantee that interference will not occur in a particular installation. If this equipment does cause harmful interference to radio or television reception, which can be determined by turning the equipment off and on, the user is encouraged to try to correct the interference by one or more of the following measures:  
-Reorient or relocate the receiving antenna.  
-Increase the separation between the equipment and receiver.  
-Connect the equipment into an outlet on a circuit different from that to which the receiver is connected.  
-Consult the dealer or an experienced radio/TV technician for help.

This equipment complies with FCC radiation exposure limits set forth for an uncontrolled environment. This equipment should be installed and operated with minimum distance 20cm between the radiator & your body.

### CE Maintenance

1. Adapter shall be installed near the equipment and shall be easily accessible.

2. Adapter:  
The plug considered as disconnect device of adapter  
Power supply and ADP(rating):  
Input: AC 100V-300V, 50-60Hz 200mA  
Output: DC 5V, 500mA

3. The device complies with RF specifications when the device used at 5mm from your body.

Declaration of Conformity  
Shanghai Laisi Information Technology Co.,Ltd hereby declares that this product is in compliance with the essential requirements and other relevant provisions of Directive 2014/53/EU.

This product is allowed to be used in all of EU member states

The product contains the following marking:

Product model: LS-T20NA / LS-T20EU  
Color: Gray  
Handle size: 173\*20\*20mm  
Weight: About 248g  
Material: Al alloy  
Rope length: 3.0 meters  
Connectivity: Bluetooth  
Battery capacity: 70mAh  
OS support: Android5.1 , iOS 9.0 and above

Product model: LS-T20LNA / LS-T20LEU  
Color: White  
Handle size: 170\*22\*22mm  
Weight: About 160g  
Material: ABS  
Rope length: 3.0 meters  
Connectivity: Bluetooth  
Battery capacity: 70mAh  
OS support: Android5.1 , iOS 9.0 and above



FCC ID : 2ATWS2019A6